

IMPERIAL FLANGE & FITTING

150# CORNER TAP FLANGE UNIONS

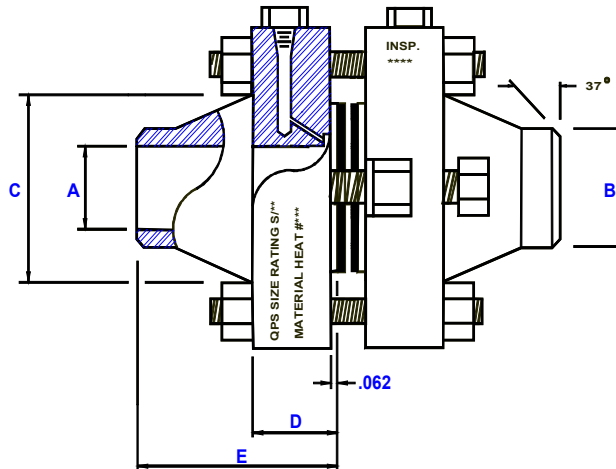

PIPE SIZE	(A) BORE	(B) POINT OF WELD	(C) HUB AT BASE	(D) MINIMUM FLANGE THICKNESS	(E) OVERALL LENGTH	PIZOMETER HOLE	PRESSURE TAP SIZE (FNPT)	DIAMETER OF RAISED FACE	DIAMETER OF BOLT CIRCLE	DIAMETER OF HOLES	NUMBER OF HOLES	SIZE OF STUDS	SIZE OF JACKSCREWS	APPROXIMATE WEIGHT
	A	B	C	D	E									
1	1.049	1.31	1.93	.562	2.18	.093	.125	2.00	3.12	.625	4	1/2 X 4-3/4	1/2 X 4	20
1-1/2	1.610	1.87	2.56	.687	2.43	.093	.125	2.87	3.87	.625	4	1/2 X 4-3/4	1/2 X 4	27
2	2.067	2.37	3.06	.750	2.50	.125	.250	3.62	4.75	.750	4	5/8 X 5-1/4	1/2 X 4	30
2-1/2	2.469	2.87	3.56	.875	2.75	.125	.250	4.12	5.50	.750	4	5/8 X 5-1/4	1/2 X 4	34
3	3.068	3.50	4.25	.937	2.75	.125	.250	5.00	6.00	.750	4	5/8 X 5-1/4	1/2 X 4	48
4	4.026	4.50	5.31	.937	3.00	.125	.250	6.18	7.50	.750	8	5/8 X 5-1/4	1/2 X 4	70
6	6.065	6.62	7.56	1.00	3.50	.125	.250	8.50	9.50	.875	8	3/4 X 5-3/4	5/8 X 4	112
8	7.981	8.62	9.68	1.12	4.00	.187	.375	10.62	11.75	.875	8	3/4 X 5-3/4	5/8 X 4	160
10	10.020	10.75	12.00	1.18	4.00	.187	.375	12.75	14.25	1.00	12	7/8 X 5-3/4	5/8 X 4	222
12	12.000	12.75	14.37	1.25	4.50	.187	.375	15.00	17.00	1.00	12	7/8 X 5-3/4	5/8 X 4	337

MATERIALS: Domestic A105 (C.S.) AND A182 (S.S.)

Other materials, styles and schedules available

HARDWARE:

Stud Bolts: A193 Gr. B7 Steel

Hex Nuts: A194 Gr. 2H Steel

Jackscrew: C1018 Hardened Square Head Screws

Pipe Plugs: Hex Head, Forged Steel

**Manufactured to meet
ASME SPECIFICATIONS**

Orifice Plates sold separate