

Imperial Flange & fitting Inc

600# RTJWN ORIFICE FLANGE UNION

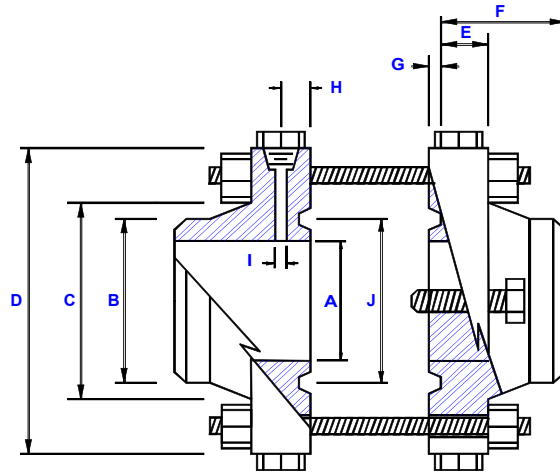

PIPE SIZE	(A) BORE	POINT OF WELD	HUB AT BASE	OUTER DIAMETER	MINIMUM FLANGE THICKNESS	OVERALL LENGTH NOTE#1	DEPTH OF RING GROOVE	TAP CENTER TO PLATE FACE	PRESSURE TAP HOLE SIZE	PITCH DIAMETER OF GROOVE	DIAMETER OF BOLT CIRCLE	DIAMETER OF HOLES	NUMBER OF HOLES	SIZE OF STUDS	SIZE OF JACKSCREWS	APPROXIMATE WEIGHT
	A	B	C	D	E	F	G	H	I	J						
1/2	.622	3.75	.84	3.75	1.25	2.75	.218	1.00	.250	1.344	2.62	.562	4	1/2 X 5-1/4	1/2 X 4	10
3/4	.824	4.62	1.05	4.62	1.25	2.87	.250	1.00	.250	1.687	3.25	.687	4	5/8 X 5-1/2	1/2 X 4	10
1	1.049	4.87	1.32	4.87	1.25	3.00	.250	1.00	.250	2.000	3.50	.687	4	5/8 X 5-1/2	5/8 X 4	15
1-1/2	1.610	6.12	1.90	6.12	1.25	3.12	.250	1.00	.250	2.687	4.50	.812	4	3/4 X 5-3/4	5/8 X 4	25
2	2.067	6.50	2.38	6.50	1.25	3.12	.312	1.00	.375	3.250	5.00	.687	8	5/8 X 5-1/2	5/8 X 4	30
2-1/2	2.469	7.50	2.88	7.50	1.25	3.25	.312	1.00	.375	4.000	5.87	.812	8	3/4 X 5-3/4	5/8 X 4	46
3	3.068	8.25	3.50	8.25	1.25	3.25	.312	1.00	.375	4.875	6.62	.812	8	3/4 X 5-3/4	3/4 X 4	56
4	*	4.50	6.00	10.75	1.50	4.00	.312	1.00	.500	5.875	8.50	1.00	8	7/8 X 6-3/4	3/4 X 4	90
6	*	6.62	8.75	14.00	1.87	4.62	.312	1.00	.500	8.312	11.50	1.12	12	1 X 7-1/2	3/4X5-1/2	197
8	*	8.62	10.75	16.50	2.18	5.25	.312	1.00	.500	10.62	13.75	1.25	12	1-1/8 X 8-1/2	3/4X5-1/2	284
10	*	10.75	13.50	20.00	2.50	6.00	.312	1.00	.500	12.75	17.00	1.37	16	1-1/4 X 9-1/2	1 X 6-1/2	472
12	*	12.75	15.75	22.00	2.62	6.12	.312	1.00	.500	15.00	19.25	1.37	20	1-1/4 X 9-1/2	1 X 6-1/2	571
14	*	14.00	17.00	23.75	2.75	6.50	.312	1.00	.500	16.50	20.75	1.50	20	1-3/8X10-1/4	1 X 6-1/2	830
16	*	16.00	19.50	27.00	3.00	7.00	.312	1.00	.500	18.50	23.75	1.62	20	1-1/2 X 11	1 X 6-1/2	1135
18	*	18.00	21.50	29.25	3.25	7.25	.312	1.00	.500	21.00	25.75	1.75	20	1-5/8X11-3/4	1 X 6-1/2	1330
20	*	20.00	24.00	32.00	3.50	7.50	.375	1.00	.500	23.00	28.50	1.75	24	1-5/8X12-1/2	1 X 8-1/2	1660
24	*	24.00	28.25	37.00	4.00	8.00	.437	**	.500	27.25	33.00	2.00	24	1-7/8X13-3/4	1 X 8-1/2	2375

NOTE #1 Overall length does not include depth of Ring Groove

* To be determined by customer

** Due to the depth of the Ring Groove the tap hole location exceeds AGA AND API Specifications

MATERIALS: Domestic A105 (C.S.) AND A182 (S.S.)

Other materials and schedules available

RTJ Orifice Plates sold separate

HARDWARE:

Stud Bolts: A193 Gr. B7 Steel

Hex Nuts: A194 Gr. 2H Steel

Jackscrew: C1018 Hardened Square Head Screws

Pipe Plugs: Hex Head, Forged Steel

Manufactured to meet
A.G.A Report #3
A.P.I 14.3
ASME SPECIFICATIONS