

# Imperial Flange & Fitting

## 300# RFWN ORIFICE FLANGE UNION

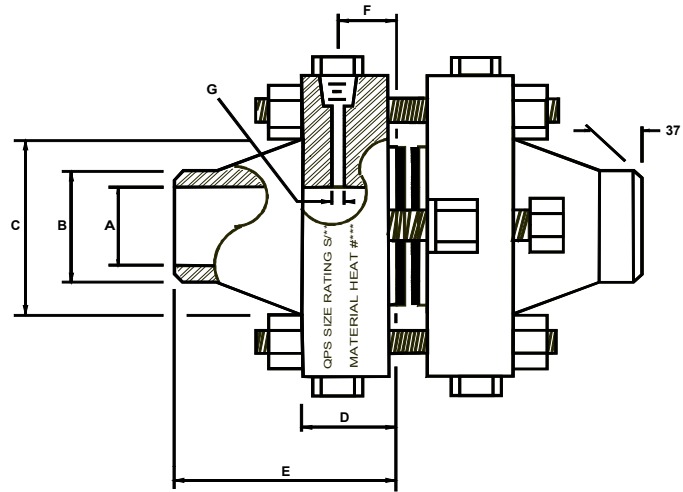

PIPE SIZE	(A) BORE	(B) POINT OF WELD	(C) HUB AT BASE	(D) MINIMUM FLANGE THICKNESS	(E) OVERALL LENGTH	(F) CENTER OF TAP	(G) PRESSURE TAP HOLE SIZE	DIAMETER OF RAISED FACE	DIAMETER OF BOLT CIRCLE	DIAMETER OF HOLES	NUMBER OF HOLES	SIZE OF STUDS	SIZE OF JACKSCREWS	APPROXIMATE WEIGHT
	A	B	C	D	E	F	G							
1/2	.622	.84	1.50	1.5	3.00	.937	.25	1.37	2.62	.562	4	1/2 X 4-3/4	1/2 X 4	10
3/4	.824	1.05	1.87	1.5	3.12	.937	.25	1.68	3.25	.687	4	5/8 X 5-1/4	1/2 X 4	10
1	1.049	1.32	2.12	1.5	3.25	.937	.25	2.00	3.50	.687	4	5/8 X 5-1/4	5/8 X 4	18
1-1/2	1.610	1.90	2.75	1.5	3.37	.937	.25	2.87	4.50	.812	4	3/4 X 5-1/4	5/8 X 4	25
2	2.067	2.38	3.31	1.5	3.37	.937	.375	3.62	5.00	.687	8	5/8 X 5-1/4	5/8 X 4	27
2-1/2	2.469	2.88	3.93	1.5	3.50	.937	.375	4.12	5.87	.812	8	3/4 X 5-1/4	5/8 X 4	35
3	3.068	3.50	4.62	1.5	3.50	.937	.375	5.00	6.62	.812	8	3/4 X 5-1/4	3/4 X 4	43
4	4.026	4.50	5.75	1.5	3.62	.937	.500	6.18	7.87	.812	8	3/4 X 5-1/4	3/4 X 4	66
6	6.065	6.63	8.12	1.5	3.93	.937	.500	8.50	10.62	.875	12	3/4 X 5-1/4	3/4 X 4	106
8	7.981	8.63	10.25	1.62	4.37	.937	.500	10.62	13.00	1.00	12	7/8 X 5-3/4	3/4 X 4	152
10	10.020	10.75	12.62	1.87	4.62	.937	.500	12.75	15.25	1.125	16	1 X 6-1/2	3/4 X 4	216
12	12.000	12.75	14.75	2.0	5.12	.937	.500	15.00	17.75	1.250	16	1-1/8 X 7	3/4 X 4	327
14	13.250	14.00	16.75	2.12	5.62	.937	.500	16.25	20.25	1.250	20	1-1/8 X 7-1/2	1 X 5-1/2	448
16	15.250	16.00	19.0	2.25	5.75	.937	.500	18.50	22.50	1.375	20	1-1/4 X 8	1 X 5-1/2	596
18	17.250	18.00	21.0	2.37	6.25	.937	.500	21.00	24.75	1.375	24	1-1/4 X 8-1/4	1 X 5-1/2	741
20	19.250	20.00	23.12	2.50	6.37	.937	.500	23.00	27.00	1.375	24	1-1/4 X 8-1/2	1 X 5-1/2	887
24	23.250	24.00	27.62	2.75	6.62	.937	.500	27.25	32.00	1.625	24	1-1/2 X 9-1/2	1 X 5-1/2	1311

**MATERIALS:** Domestic A105 (C.S.) AND A182 (S.S.)

*Other materials and schedules available*

**HARDWARE:**

- Stud Bolts: A193 Gr. B7 Steel
- Hex Nuts: A194 Gr. 2H Steel
- Jackscrew: C1018 Hardened Square Head Screws
- Pipe Plugs: Hex Head, Forged Steel

**Manufactured to meet**

A.G.A Report #3

A.P.I 14.3

**ASME SPECIFICATIONS**

*Orifice Plates sold separate*