

# Imperial Flange & fitting Inc

## 2500# RTJWN ORIFICE FLANGE UNION

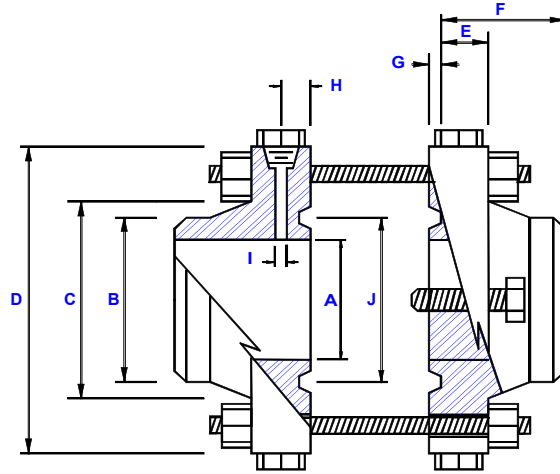

PIPE SIZE	(A) BORE	POINT OF WELD	HUB AT BASE	OUTER DIAMETER	MINIMUM FLANGE THICKNESS	OVERALL LENGTH NOTE#1	DEPTH OF RING GROOVE	TAP CENTER TO PLATE FACE	PRESSURE TAP HOLE SIZE	PITCH DIAMETER OF GROOVE	DIAMETER OF BOLT CIRCLE	DIAMETER OF HOLES	NUMBER OF HOLES	SIZE OF STUDS	SIZE OF JACKSCREWS	APPROXIMATE WEIGHT
	A	B	C	D	E	F	G	H	I	J						
1	*	1.31	2.50	6.25	1.37	3.50	.250	1.00	.250	2.375	4.25	1.00	4	7/8 X 6-1/4	5/8 X 4	26
1-1/2	*	1.87	3.12	8.00	1.75	4.37	.312	1.00	.250	3.250	5.75	1.25	4	1-1/8 X 7-1/2	3/4 X 5-1/2	56
2	*	2.37	3.75	9.25	2.00	5.00	.312	1.00	.375	4.000	6.75	1.12	8	1 X 7-3/4	3/4 X 5-1/2	84
2-1/2	*	2.87	4.50	10.50	2.25	5.62	.375	1.00	.375	4.375	7.75	1.25	8	1-1/8 X 8-1/2	3/4 X 5-1/2	104
3	*	3.50	5.25	12.00	2.62	6.62	.375	1.00	.375	5.000	9.00	1.37	8	1-1/4 X 9-1/2	3/4 X 6-1/2	188
4	*	4.50	6.50	14.00	3.00	7.50	.437	**	.500	6.187	10.75	1.62	8	1-1/2 X 11	3/4 X 6-1/2	292
6	*	6.62	9.25	19.00	4.25	10.75	.500	**	.500	9.000	14.50	2.12	8	2 X 14-3/4	3/4 X 8-1/2	756
8	*	8.62	12.00	21.75	5.00	12.50	.562	**	.500	11.000	17.25	2.12	12	2 X 16-1/2	1 X 9-1/2	1152
10	*	10.75	14.75	26.50	6.50	16.50	.687	**	.500	13.500	21.25	2.62	12	2-1/2 X 20-3/4	1 X 12-1/2	2136
12	*	12.75	17.37	30.00	7.25	18.25	.687	**	.500	16.000	24.37	2.87	12	2-3/4 X 22-3/4	1 X 13	3216

**NOTE #1** Overall length does not include depth of Ring Groove

\* To be determined by customer

\*\* Due to the depth of the Ring Groove the tap hole location exceeds AGA AND API Specifications

**MATERIALS:** Domestic A105 (C.S.) AND A182 (S.S.)

*Other materials and schedules available*

**HARDWARE:**

**Stud Bolts:** A193 Gr. B7 Steel

**Hex Nuts:** A194 Gr. 2H Steel

**Jackscrew:** C1018 Hardened Square Head Screws

**Pipe Plugs:** Hex Head, Forged Steel

**Manufactured to meet**

**A.G.A Report #3**

**A.P.I 14.3**

**ASME SPECIFICATIONS**

**RTJ Orifice Plates sold separate**